

Whilst every attempt has been made to ensure the accuracy of the floor plan contained here, measurements of doors, windows, rooms and any other items are approximate and no responsibility is taken for any error, omission, or mis-statement. This plan is for illustrative purposes only and should be used as such by any prospective purchaser. The services, systems and appliances shown have not been tested and no guarantee as to their operability or efficiency can be given  
Made with Metropix ©2021

TOTAL APPROX. FLOOR AREA 349 SQ.FT. (32.5 SQ.M.)

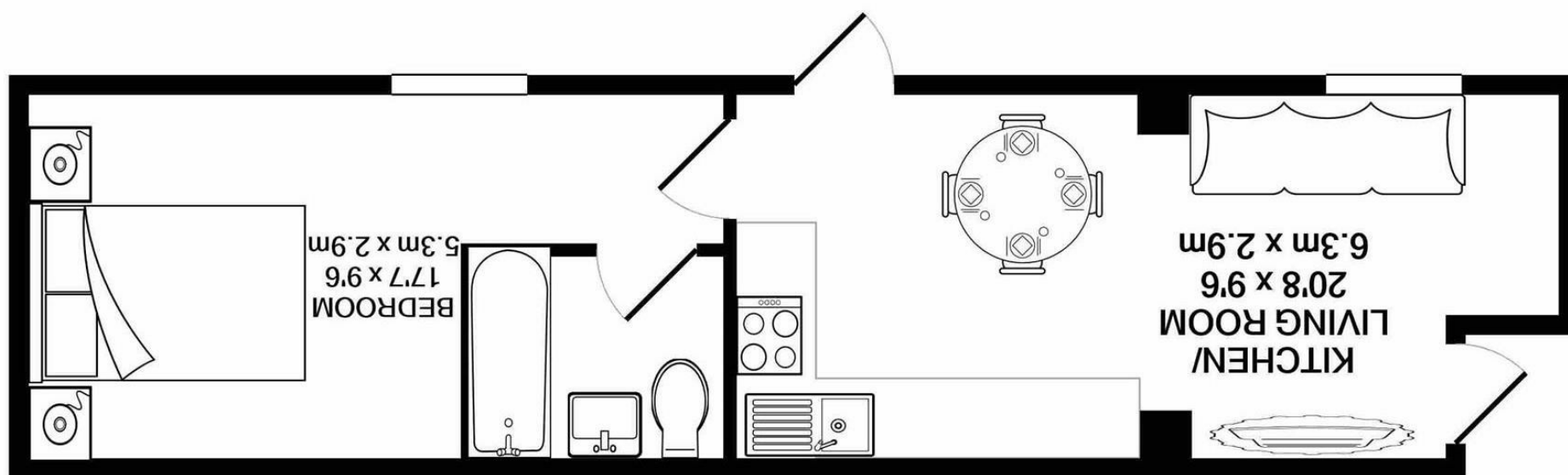

SILVERMAN  
BLACK  
PROPERTY SPECIALISTS





# 13 High Street

Carshalton, SM5 3AP

£225,000

Brand New Apartment - with private entrance. This is one of eight luxury apartments, situated right in the heart of Carshalton Village. The property offers accommodation incorporating a Living Room with a fully integrated kitchen, a generous Double Bedroom and a good size Bathroom suite. Externally, the property affords easy access to all of the shopping and restaurant facilities of Carshalton High Street, whilst All Saints Church, the Ponds and The Grove are all on your doorstep. Carshalton BR station is about a five minute walk away - meaning that Central London is approximately 33 minutes away, door-to-door. All apartments will be fully double glazed, centrally heated and be provided with brand new 125 year leases. The developers have registered the site under the London Help to Buy Scheme. Viewing is highly recommended - and appointments are already being booked in - so book today!

